



# SERIES AP 1300

## SINGLE STAGE REGULATOR

### High Flow Line Regulator

- SS 316L VAR construction
- High flow free poppet design
- 10  $\mu$ m. surface finish standard
- Flow rates to 1,000 slpm (35 scfm)
- Line regulator for specialty and bulk gases
- Vacuum to 300 psig (21 bar) inlet
- Installation and operating instructions available at [www.aptech-online.com](http://www.aptech-online.com) in the Tech Briefs section

#### Operating Parameters

Source pressure	AP 1300	vacuum to 300 psig (21 bar)
Delivery pressure	AP 1302	1 to 30 psig (0.07 to 2 bar)
	AP 1306	2 to 60 psig (0.14 to 4 bar)
	AP 1310	2 to 100 psig (0.14 to 7 bar)
	AP 1315	5 to 150 psig (0.34 to 10 bar)
Proof pressure		450 psig (31 bar)
Burst pressure		1,200 psig (83 bar)

#### Other Parameters

Inlet/outlet connectors	1/4, 3/8, 1/2 inch face seal or tube weld
Flow coefficient (Cv)	1.1
Internal volume	1.19 in <sup>3</sup> (19.6 cm <sup>3</sup> )
Operating temperature	-40° to +160°F (-40° to +71°C)
Surface finish	15 $\mu$ m Ra max / 10 $\mu$ m. Ra avg. (0.4/0.25 $\mu$ m) standard; 10 $\mu$ m (0.25 $\mu$ m); 7 $\mu$ m (0.18 $\mu$ m); and 5 $\mu$ m (0.13 $\mu$ m) Ra max optional
Inboard leakage	2 x 10 <sup>-10</sup> sccs
Outboard leakage	1 x 10 <sup>-9</sup> sccs He
Leakage across seat	4 x 10 <sup>-8</sup> sccs He
Installation	surface or panel (optional)
Supply pressure effect	4.6 psig per 100 psig source pressure change

#### Materials

Type of Service	Series AP 1300 S Noncorrosive	Series AP 1300 SHP Corrosive
Wetted Parts		
Body	stainless steel 316L secondary remelt	stainless steel 316L secondary remelt
Nozzle	stainless steel 316L	stainless steel 316L
Poppet	stainless steel 316L	Ni-Cr-Mo alloy / UNS N06022
Diaphragm	Ni-Cr-Mo alloy / UNS N06022	Ni-Cr-Mo alloy / UNS N06022
Finish	electropolished and passivated	electropolished and passivated
Seat	PCTFE (PTFE optional)	PCTFE (PTFE optional)

All specifications subject to change without notice.

# SERVICE AND SUPPORT BEYOND COMPARE

## DIMENSIONAL INFORMATION

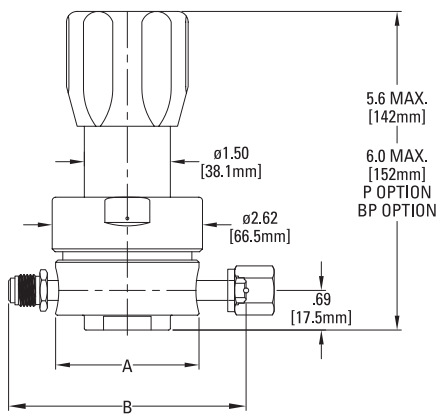

Face Seal	A	B
1/4" Male	2.00" (51 mm)	4.00" ±.02 (102 mm)
1/4" Female	2.00" (51 mm)	3.70" ±.02 (94 mm)
3/8"	2.50" (64 mm)	5.22" ±.03 (133 mm)
1/2"	2.50" (64 mm)	5.22" ±.03 (133 mm)
3/4"	2.50" (64 mm)	6.26" ±.04 (159 mm)

All dimensions in inches (mm). Metric dimensions are for reference only.

## PORTING CONFIGURATIONS

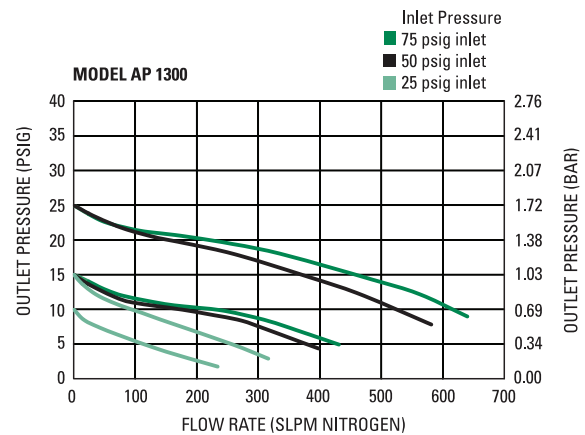
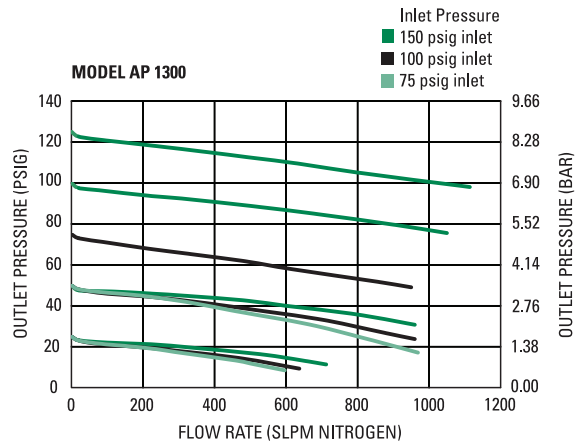
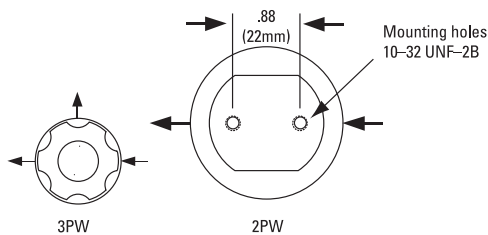

**CAUTION: Product selection is the sole responsibility of the user, regardless of any recommendations or suggestions made by the factory. The user shall make selections based upon their own analysis and testing with regard to function, material compatibility and product ratings. Proper installation, operation and maintenance are also required to assure safe, trouble free performance.**

## ORDERING INFORMATION

Sample Order Number	AP 1310SM 3PW FV8 FV8 1	
<b>AP 1310   Series</b>	AP 1302 = 1-30 psig (.07 to 2 bar) AP 1306 = 2-60 psig (.14 to 4 bar) AP 1310 = 2-100 psig (.14 to 7 bar) AP 1315 = 5-150 psig (.34 to 10 bar)	<b>FV8 FV8   Connections Inlet / Outlet</b>  FV4 = 1/4 inch face seal female MV4 = 1/4 inch face seal male FV6 = 3/8 inch face seal female MV6 = 3/8 inch face seal male FV8 = 1/2 inch face seal female MV8 = 1/2 inch face seal male FV12 = 3/4 inch face seal female MV12 = 3/4 inch face seal male Tube weld stub available
<b>S   Material</b>	S = Stainless steel (SS) SHP = SS/Ni-Cr-Mo alloy poppet and diaphragm	<b>1   Gauges/Delivery</b>  0 = No gauge V3 = 30-0-30 psig/bar L = 30-0-60 psig/bar 1 = 30-0-100 psig/bar H = 30-0-160 psig/bar
<b>M   Surface Finish Options</b>	M = 10 µin. Ra max V = 7 µin. Ra max X = 5 µin. Ra max	
<b>3PW   Ports</b>	2PW = 2 ports butt weld 3PW = 3 ports butt weld	<b>P   Options</b>  P = Panel installation ring TF = PTFE seat BP = Bonnet port 1/8 inch NPT Panel hole 1.56" diameter.

ООО «Армада»

191036, г. Санкт-Петербург, ул. 8-я Советская, дом 26 лит. А, пом. 20-Н Тел.: +7 (812) 642-85-75 arm-lok@mail.ru, arm-lok.ru